



◦ ◦ ◦ **ZVOX** Z-Base™ 575 ◦ ◦ ◦  
Single-Cabinet Surround Sound System

---

**O W N E R ' S M A N U A L**

---

Don't Worry—This Is Going To Be Simple



**ZVOX**®

Great Sound Made Simple

# READ THIS FIRST

## Important Safety Instructions For ZVOX 575 System

# WARNING

- TO PREVENT FIRE OR SHOCK HAZARD, DO NOT EXPOSE THIS APPLIANCE TO RAIN OR MOISTURE.
- THIS APPLIANCE SHOULD NOT BE EXPOSED TO DRIPPING OR SPLASHING WATER AND NO OBJECT FILLED WITH LIQUIDS SUCH AS VASES SHALL BE PLACED ON APPARATUS.

## CAUTION

RISK OF ELECTRICAL SHOCK,  
DRY LOCATION USE ONLY

## ATTENTION

POUR UTILISATION  
A L'INTERIEUR



CAUTION: TO REDUCE THE RISK OF ELECTRICAL SHOCK,  
DO NOT REMOVE COVER (OR BACK)  
NO USER SERVICEABLE PARTS INSIDE  
REFER SERVICING TO QUALIFIED SERVICE PERSONNEL



 The lightning flash with arrowhead symbol, within an equilateral triangle, is intended to alert the user to the presence of uninsulated "dangerous voltage" within the product's enclosure that may be of sufficient magnitude to constitute a risk of electric shock to persons.

 The exclamation point within an equilateral triangle is intended to alert the user of the presence of important operating and maintenance (servicing) instructions in the literature accompanying this product.

**All safety and operating instructions should be read before your ZVOX® 575 is operated.**

**Safety instructions and operating instructions should be kept for future reference.**

**All warnings on the product or in the operating instructions should be followed. Operate your ZVOX 575 in accordance with the instructions.**



**Do Not Use Near Water.** Do not use your ZVOX 575 near water, such as a bathtub, sink, swimming pool or wet basement. To reduce the risk of fire or electric shock, do not expose this apparatus to rain or moisture. To avoid dripping and splashing, no objects filled with liquids, such as vases, should be placed on your ZVOX 575.



**Object Entry.** Never use probes of any kind to reach into the ZVOX 575 as they may touch voltage points or short parts that could result in a fire or electric shock.

**Ventilation.** The heat sink (a black metal panel located on the back of the ZVOX 575) REQUIRES ventilation to ensure reliable operation of the system and to prevent it from over-heating. This area must not be blocked or covered. Do not allow a soft surface such as carpet, bedding or a sofa to cover the heat sink. The system should not be placed in a built-in installation such as a bookcase or a rack unless proper ventilation is provided.



**Do Not Abuse The Power Cord.** Install the ZVOX 575 where no one can step on or trip on the power cord. Never yank to disconnect the cord from an outlet. Keep the cord away from heated surfaces. Do not pull the cord around sharp edges or corners. Do not allow cord to hang over the edge of table or counter.



**Heat.** Place system away from radiators, stoves, heat vents or other heat sources.



**Do not defeat the safety purpose of the polarized or grounding type plug.** A polarized plug has two blades with one wider than the other. The wide blade is provided for your safety. If the provided plug does not fit into your outlet, consult an electrician for replacement of the obsolete outlet.



**Power Supply.** Do not use a power supply with a higher voltage rating than the unit supplied.



**Power Sources.** The ZVOX 575 can be operated only with a 60HZ 120VAC power source.



**Do Not Overload Outlets.** Don't overload your wall outlets or power strip. This can result in the risk of fire or electric shock.



**Damage Requiring Service.** Unplug your ZVOX 575 and refer servicing to an authorized service center when the following conditions occur:

- When the power supply cord or plug is damaged or frayed.
- If liquid is spilled into the unit.
- If the unit has been exposed to rain or water.
- If the unit does not work normally by following the operating instructions.
- If the unit has been dropped or physically damaged.
- If the unit exhibits a distinct change in performance.



**Lightning.** Unplug your unit during a lightning storm, or when it is left unattended and unused for long periods of time. This will prevent damage due to lightning and power line surges.



**Unplug Before Cleaning.** Unplug your ZVOX system from wall outlet or other power source before cleaning. Use a damp cloth for cleaning. Do not use solvents or chemical cleaning agents.



**Disconnect Device.** The MAINS plug is used as the disconnect device. Do not do anything to make it difficult to disconnect the MAINS power plug—it should remain readily operable.



**Attachments.** Do not use any adapters or attachments not recommended by ZVOX Audio, as they may cause hazards.



**Servicing.** Do not attempt to service this product yourself. Do not remove the cover. Refer all servicing to qualified service personnel.



**Replacement Parts.** Do not allow anyone to use replacement parts other than those recommended by the manufacturer. Unauthorized substitutions may result in fire, electric shock or other hazards.



**Safety Check.** Upon completion of any service or repair to this product, ask the service technician to perform safety checks to determine whether the product is in proper operating condition.

## Special Safety Warnings Regarding Placement of ZVOX 575 and Other Equipment



**Stable Placement.** Do not place the ZVOX 575 on an unstable cart, stand, bracket or table. The ZVOX 575 may fall, causing serious injury to a child or adult and serious damage to the product. Do not use the ZVOX 575 on any unstable surface.

**Placement of a TV on the ZVOX 575.** Televisions weighing less than 140 pounds, and with base dimensions of less than 34" in width and less than 15" in depth, can be placed on top of the ZVOX 575 — BUT ONLY WHEN THE FOLLOWING SAFETY PRECAUTIONS ARE STRICTLY OBSERVED. PLACING A TV ON TOP OF THE 575 WITHOUT FOLLOWING ALL THE PRECAUTIONS IS DANGEROUS AND SHOULD NOT BE DONE.

- The television must weigh 140 pounds or less.
- The base of the TV, or the TV stand, must be 34" wide or less.
- The base of the TV, or the TV stand, must be 15" deep or less.
- The TV MUST be anchored to the rear wall using anchor bolts and supporting cables supplied by the TV manufacturer, following the installation guidelines provided by the TV manufacturer.
- Be sure to take measures to prevent the ZVOX 575 from becoming uneven or unstable. Install the ZVOX 575 on a solid and flat surface.

# Installation and Operating Instructions: ZVOX 575 Single-Cabinet Surround Sound System

## Contents

ZVOX Audio ZVOX 575 cabinet  
AC power cord  
Remote Control and Battery  
Main Audio Cable (left and right RCA type plugs on each end)  
Aux Audio Cable (stereo miniplug at one end, left and right RCA type plugs on the other end)

## Placement

Place the ZVOX 575 cabinet on a sturdy surface.  
The ZVOX 575 cabinet should face the listening area.

## Power Connection

- 1 Connect the AC power cord to the 120V~60Hz Power Connector on the back of the ZVOX 575 cabinet.



**WARNING: DON'T PLUG AC CORD INTO OUTLET BEFORE IT IS CONNECTED TO THE POWER CONNECTOR ON THE REAR OF THE UNIT.**

- 2 After you have confirmed the AC power cord is properly connected to ZVOX 575, connect the AC power cord plug into a convenient AC receptacle.
- 3 After you have made the necessary audio signal connections (see below), set the POWER switch on the back of the ZVOX 575 to ON.

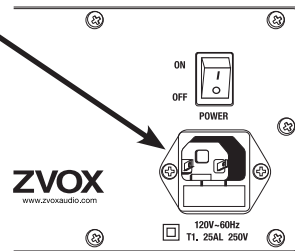

Rear AC panel of ZVOX 575

## Audio Signal Connection

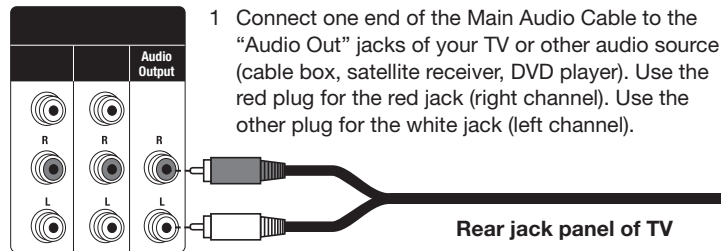

- 1 Connect one end of the Main Audio Cable to the "Audio Out" jacks of your TV or other audio source (cable box, satellite receiver, DVD player). Use the red plug for the red jack (right channel). Use the other plug for the white jack (left channel).

- 2 Connect the plugs on the other end of the Audio Cable in the same manner to the red and white INPUT 1 jacks on the back of the ZVOX 575 cabinet.

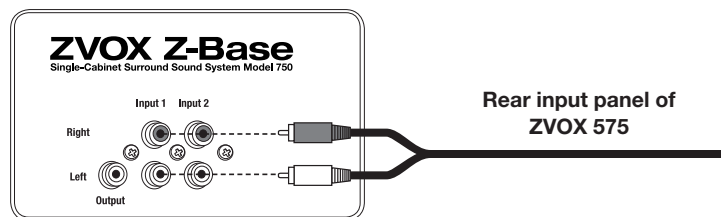

Rear input panel of ZVOX 575

## Turn Off Your TV's Internal Speakers

- 1 Push the MENU button on the TV's remote control and navigate to the AUDIO setting options.
- 2 Choose SPEAKER: OFF (the wording may vary).
- 3 If available, set AUDIO OUT to VARIABLE (the wording may vary). This is sometimes labeled AOV. Some TVs do not provide this option. In this case, the TV's audio output will either be FIXED or VARIABLE.

NOTE: VARIABLE AUDIO OUTPUT ON YOUR TV ALLOWS YOU TO CONTINUE TO USE YOUR TV'S REMOTE CONTROL TO ADJUST THE LISTENING VOLUME. IF YOUR TV'S AUDIO OUTPUT IS FIXED, THEN YOU USE THE ZVOX 575 REMOTE CONTROL TO ADJUST AUDIO OUTPUT.

NOTE: A UNIVERSAL OR PROGRAMMABLE/LEARNING REMOTE CAN BE SUBSTITUTED TO CONTROL THE ZVOX 575, YOUR TV AND OTHER CONNECTED DEVICES. THE ZVOX 575 WILL RESPOND TO THE FOLLOWING PREPROGRAMMED AUDIO REMOTE CODES: CANDLE 1004/HISENSE 1237/AIWA 1036.

## ZVOX 575 Connectors

**OUTPUT jack:** The output of this jack is full-range monaural audio. Connect this jack to an external powered subwoofer, should one be available. If possible, set the subwoofer's crossover (sometimes labeled "Low Pass") to 50 to 60 Hz, then adjust the subwoofer's output to blend well with the ZVOX 575.

**INPUT 1 jacks:** Use to connect a TV, PC or other audio source

**INPUT 2 jacks:** Use this input only after INPUT 1 has an audio source. Audio on this input mixes with the audio from INPUT 1.

## Remote Control

1. Insert the AAA batteries in the ZVOX 575 remote control.
2. Turn on the ZVOX 575 by pushing the power button on the remote control. A blue LED light should come on.

**NOTE: IN NORMAL OPERATION THE UNIT WILL GO INTO STANDBY MODE 2-3 MINUTES AFTER IT STOPS RECEIVING AN AUDIO SIGNAL (FOR EXAMPLE, WHEN YOU TURN OFF YOUR TV). THE FRONT PANEL LIGHT WILL TURN FROM BLUE TO GREEN IN STANDBY MODE. WHEN THE SIGNAL RETURNS (AFTER YOU TURN YOUR TV ON), THE LIGHT WILL TURN BLUE AGAIN. TO DEFEAT THIS "AUTOMATIC STANDBY" MODE, PRESS THE "AUTO ON/OFF" BUTTON ONCE (THE LIGHT WILL BLINK). TO RESTORE THE SETTING, PRESS THE BUTTON AGAIN.**

3. Adjust volume with the Volume "+" and "-" buttons. Note that the blue LED light under the grille will flash with every push of a button. When you have reached maximum (or minimum) volume, the blue LED will stop blinking. The LED reacts this way for all settings—VOLUME, PHASECUE™, SUBWOOFER and TREBLE.
4. When "MUTE" button is pushed, and volume is muted, the blue LED will flash until volume is unmuted with a second push of the button.
5. PHASECUE buttons control the ZVOX virtual surround sound system. There are nine (9) levels of PHASECUE adjustment. When you turn up the PHASECUE control, the audio should sound wider or "bigger." In many cases you will hear sounds from places where there are no speakers. This effect is stronger with live music, live sporting events and well-recorded movies and TV programs. With many programs—especially news shows and sitcoms—PHASECUE will have little effect.

**NOTE: IF YOU FIND THAT CROWD NOISES OR MOVIE SPECIAL EFFECTS ARE "DROWNING OUT" THE DIALOG, TRY TURNING DOWN THE PHASECUE CONTROL. THIS WILL PUT MORE FOCUS ON DIALOG CLARITY.**

6. There are nine (9) levels of SUBWOOFER control. You may need to experiment with SUBWOOFER levels because speaker position and program material have a big effect on bass. If the audio sounds thin, try turning up the SUBWOOFER control. If the bass sounds overly loud, "boomy" or distorted, turn down the SUBWOOFER control.
7. There are nine (9) levels of TREBLE control. The adjustment this control makes is very subtle. Experiment until you think the sound is not too "bright" and not too "dull." Most people set the treble control once and leave the setting in that position.

## Fine Tuning

If you hear a consistent hiss or hum from the ZVOX 575, it is likely you are using a variable audio signal output from your TV but ZVOX 575's volume is set too high. Lower the setting on the ZVOX 575 remote VOLUME by at least three steps or until the hiss is reduced, then set it aside. Use a higher volume setting on your TV remote from this point forward.

Please keep in mind that your ZVOX 575 is a highly accurate audio system. It may reveal noise, distortion or other flaws inherent in some audio programs that were masked with smaller TV speakers.

The PhaseCue control adjusts the size of the perceived "soundstage". Feel free to adjust it for different kinds of programs. In general, movies and live action video programming benefit from a higher setting than music concert programming. Remember, there are nine discrete steps of PhaseCue effect.

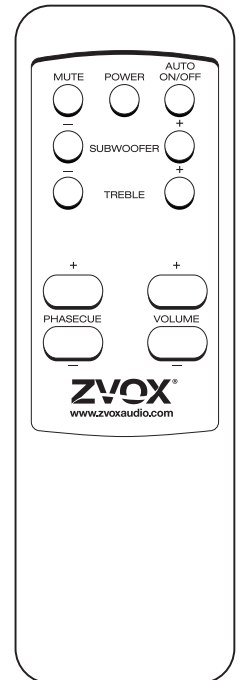

## 1-Year Limited Warranty

To the original purchaser, ZVOX Audio will warrant the ZVOX 575 system to be free of defects in material and workmanship for a period of one (1) year from date of purchase. With respect to defects, ZVOX will, at its option, replace the product or repair the defect in the product with no charge to the original purchaser for parts or labor. Customer is responsible for shipping charges where required.

This warranty does not extend to any defect, malfunction or failure caused by misuses, abuse, accident, faulty hookup, defective associated equipment or use of the system with equipment for which it is not intended.

This warranty is only valid when the system is returned to the retailer that sold the ZVOX 575 system to the original purchaser.

This is the sole and express warranty. This warranty is in lieu of all other warranties, expressed or implied, of merchantability, fitness for purpose or otherwise. In no event shall ZVOX Audio LLC be liable for incidental or consequential damages or have any liability with respect to defects other than the obligations set forth as stated. Except as provided herein, ZVOX Audio LLC shall have no liability or responsibility to the purchaser or any other person or entity with respect to any liability, loss or damage caused directly or indirectly by use of the product, including, but not limited to, any incidental or consequential damages.

To ensure warranty coverage, it is incumbent upon the original purchaser of the ZVOX 575 system to inform the retailer of the defect within the warranty period.

The only acceptable method of establishing warranty status is a copy of the original proof of purchase indicating customer's name and purchase date.

The ZVOX logo is rendered in a bold, white, sans-serif font with a registered trademark symbol (®) to the upper right of the 'X'. The letters are thick and have a slight shadow effect, giving them a three-dimensional appearance. The logo is centered horizontally and is the largest text element on the page.

Great Sound Made Simple

Questions? E-mail us at [info@zvoxaudio.com](mailto:info@zvoxaudio.com)